

CREATING SEAMLESS SOLUTIONS

Seamless™ Access Panels by Castle are manufactured direct, manufactured from **GFRG/GFRC & 70% post-consumer recycled glass**, for a unique **GREEN** design-matrix designed to blend seamlessly into your walls and ceilings. They consist of a surround frame and either a drop-in door or hinged door. Available in Twenty standard residential or commercial sizes, Castle panels are perfect for jobs where access is required at regular intervals. Lightweight and easily textured, the panels can be used in both new and retrofit construction across unlimited applications. Their smart design to help contractors work smarter, faster and better, the Seamless™ panels feature a tapered edge for tape joints and won't shrink, crack or sag. Seamless™ Access Panels provide an aesthetically pleasing solution for a more attractive interior.

PRODUCT FEATURES

- Tapered edge for tape joint
- Lightweight
- No shrinking, cracking, sagging or rusting
- Concealed hinge
- Moisture resistant
- Easily textured
- Single trade installation
- Blends seamlessly into surrounding drywall
- Reduce labor costs
- Zero mold & fungus growth

Square or Radius Corners POP-OUT ACCESS PANELS

Part Code	Access Opening	Rough Opening
580009	9" x 9"	15" x 15"
580012	12" x 12"	18" x 18"
581218	12" x 18"	18" x 24"
580016	16" x 16"	22" x 22"
580018	18" x 18"	24" x 24"
580020	20" x 20"	26" x 26"
580024	24" x 24"	30" x 30"
580030	30" x 30"	36" x 36"
581236	12" x 36"	18" x 42"
581836	18" x 36"	24" x 42"

- * CUSTOM SIZES AVAILABLE
- * ROUND POP-OUT PANELS AVAILABLE
- * NEOPRENE GASKET AVAILABLE UPON REQUEST

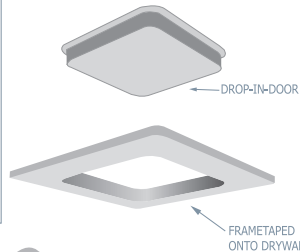

COLOR FINISH: UNPAINTED
NATURAL GREY GYPSUM

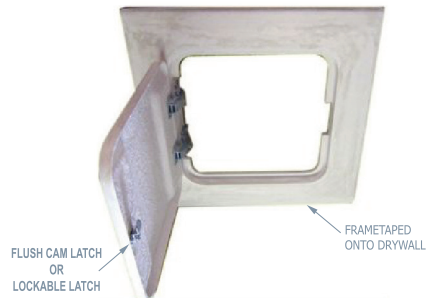
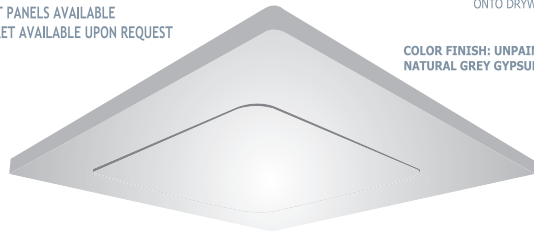

HINGED ACCESS PANELS

Part Code	Access Opening	Rough Opening
HG-580009	9" x 9"	15" x 15"
HG-580012	12" x 12"	18" x 18"
HG-580016	16" x 16"	22" x 22"
HG-580018	18" x 18"	24" x 24"
HG-580024	24" x 24"	30" x 30"

- * CUSTOM SIZES AVAILABLE
- * NEOPRENE GASKET AVAILABLE UPON REQUEST

HOW TO INSTALL ACCESS PANELS

1. Frame the opening.
2. Mount Seamless™ surround with drywall screws.
3. Mounted frame.
4. Install drywall and place access panel in opening.
5. Tape and apply drywall compound.
6. Apply desired finish.

General Drawing Pop-Out or Hinged

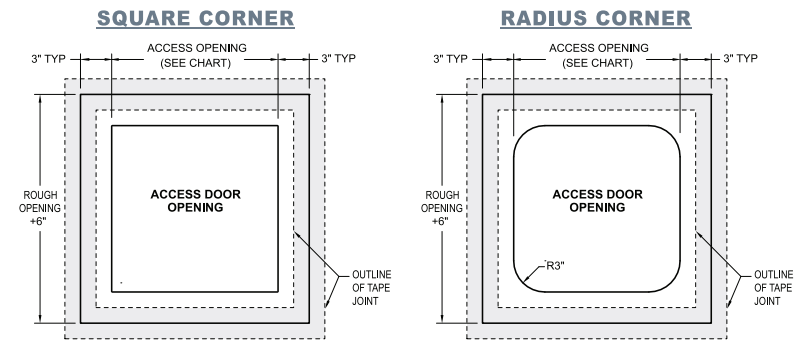

Pop-Out Specification

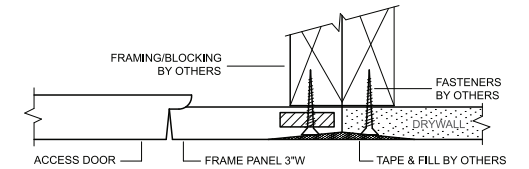

Hinged Specification

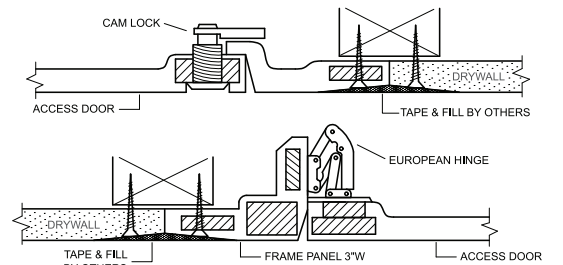

Designed for both wall and ceiling applications, the hinged **Seamless™** Panel by **Castle** can be used where a locked door is needed but style must still be maintained. The hinged panel is great for use in ceiling applications where there is no space to push a door up, and in wall applications when access to plumbing and electrical is needed.

- The **Seamless™** Hinged Access Panel and Pop-out Panel consists of a frame door with concealed hinges and a cam or key lock.
- Round Pop-out Panel available in 5 sizes.
- **Neoprene Gasket** available for all panels upon request.
- These panels require extra reinforcement and a crate or pallet to ship.
- Ships directly from the manufacturing plant in Concord, ON Canada.

SEAMLESS PANELS TECHNICAL DATA

Shell Thickness	1/8" to 3/16"
Fastener Test Pull Out (wood stud)	525 lb avg.
Fastener Test Pull Out (metal stud)	215 lb avg.
Fastener Push Through Test	350 lb avg.
Fuel Contribution (ASTM E84-80)	0
Flame Spread (ASTM E84-80)	0
Smoke Index (ASTM E84-80)	0
Combustion (ASTM E84-80)	Non-combustible
Class A Non-Rated	—

DEALERS/DISTRIBUTORS

CASTLE ACCESS PANELS & FORMS INC.
173 Adesso Dr. Unit 2, Concord, ON L4K 3C3, Canada
www.CastleAccessPanels.com

Phone: (905)738-8089
Fax: (905)760-9234
Email: inquiries@castleaccesspanels.com