

# GFRG POP-OUT ACCESS PANEL

## RADIUS CORNER - RC-580024

TOP VIEW

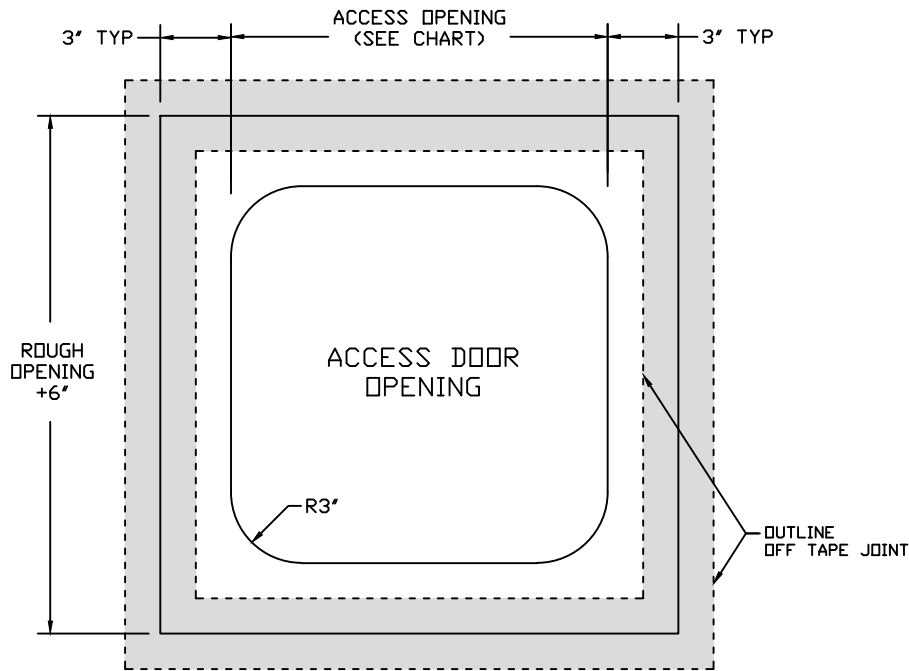

SECTION VIEW

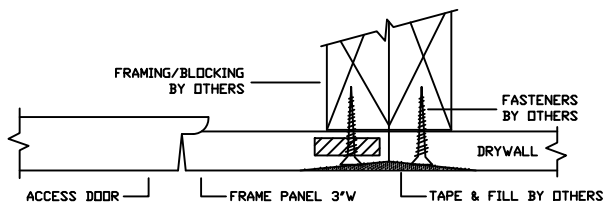

### GFRG RADIUS CORNER POP-OUT ACCESS PANEL

AVAILABLE PRODUCT ITEMS SCHEDULE

STOCK#	ACCESS DOOR OPENING SIZE	ROUGH OPENING SIZE
RC-580005	5" x 5"	11" x 11"
RC-580006	6" x 6"	12" x 12"
RC-580008	8" x 8"	14" x 14"
RC-580009	9" x 9"	15" x 15"
RC-580010	10" x 10"	16" x 16"
RC-580012	12" x 12"	18" x 18"
RC-580014	14" x 14"	20" x 20"
RC-580016	16" x 16"	22" x 22"
RC-580018	18" x 18"	24" x 24"
RC-580020	20" x 20"	26" x 26"
RC-580024	24" x 24"	30" x 30"
RC-580030	30" x 30"	36" x 36"
RC-580036	36" x 36"	42" x 42"
RC-580040	40" x 40"	46" x 46"
RC-580048	48" x 48"	54" x 54"
RC-581216	12" x 16"	18" x 22"
RC-581218	12" x 18"	18" x 24"
RC-581224	12" x 24"	18" x 30"
RC-581236	12" x 36"	18" x 42"
RC-581836	18" x 36"	24" x 42"
RC-582436	24" x 36"	30" x 42"
RC-582448	24" x 48"	30" x 54"
RC-582472	24" x 72"	30" x 78"
RC-582478	24" x 78"	30" x 84"
RC-584260	42" x 60"	48" x 66"
RC-584272	42" x 72"	48" x 78"

CUSTOM SIZE AVAILABLE.  
NEOPRENE GASKET AVAILABLE UPON REQUEST.

THIRD ANGLE PROJECTION 	 <b>CASTLE</b> Access Panels & Forms Inc.	<b>CASTLE ACCESS PANELS &amp; FORMS INC.</b> 173 Adesso Drive, Unit 2, Concord ON L4K 3C3 Phone (905)738-8089 Fax (905)760-9234 inquiries@castleaccesspanels.com www.CastleAccessPanels.com	DESIGNED: DATE:
			APPROVED: J. R. DATE:
SCALE:	UNITS:	CUSTOMER:	PROJECT:
		TITLE:	DWG NO:
			QTY: SHEET 1 OF 1